

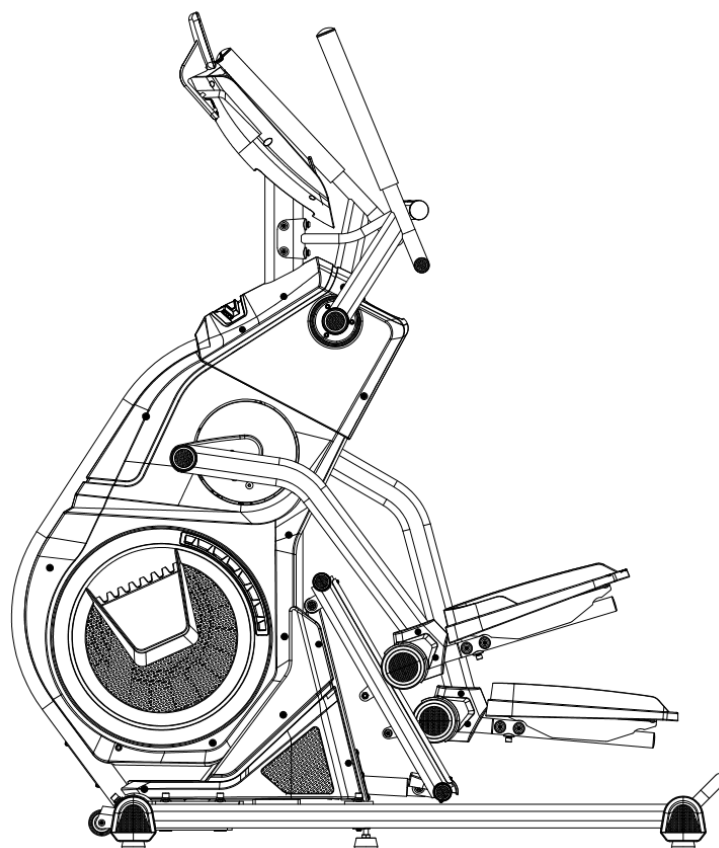

USER MANUAL – EN
IN 16186 Stepper inSPORTline AVALOR ST



CONTENTS

- INTRODUCTION..... 3
- SAFETY PRECAUTIONS..... 3
- EXPLODED DRAWINGS 4
- PARTS LIST 6
- PRODUCT DESCRIPTION 9
- PRODUCT SPECIFICATION 9
- HARDWARE LIST 10
- ASSEMBLY STEPS 12
- EXERCISE INSTRUCTIONS 17
- CONSOLE OPERATON INSTRUCTION 18
- Functional description:..... 18
- Main function Description 18
- OPERATION DESCRIPTION..... 21
 - POWER ON: 21
 - SLEEP:..... 21
 - MANUAL MODE (PRESS START/STOP KEY)..... 23
 - PROGRAM MODE 23
 - USER MODE 25
 - HRC MODE..... 25
 - WATT MODE 26
 - KEY OPERATING..... 27
 - BODY FAT 28
- TERMS AND CONDITIONS OF WARRANTY, WARRANTY CLAIMS..... 29

INTRODUCTION

Thank you for purchasing this product. To use it properly and safely, read the entire manual and observe all warnings and recommendations.

SAFETY PRECAUTIONS

- **WARNING!** This product has been designed to offer the maximum safety. Nevertheless, certain precaution should be kept while using it. Read the whole manual before first using and retain it for future reference.
- It's the owner responsibility to use it safely and properly. Instruct all other users in correct using.
- Use this product only for intended purpose. Don't do any improper modification.
- Keep it away from children and pets. Never let children unattended near this device.
- Regularly check all bolt, nuts and components, if they are well tightened. Retighten, if necessary. Regularly check this machine for damage or wearing. Never use damaged or worn product. All damager or worn parts should be replaced immediately.
- Place it only on a flat, clear and solid surface and keep a safety clearance of at least 0.6 m round it. Put a mat under this device to protect your floor.
- Use it only indoors and protect it from humidity and dust. Assure sufficient ventilation. Never exercise in an airless place.
- Don't put any sharp objects on or near this stepper.
- Always wear appropriate clothes and sports shoes. Avoid too loose dress that can be caught in device.
- Keep your hands away from moving parts to avoid an injury. No adjustable part should protrude and obstruct user movements.
- Control your speed and exercise reasonably.
- If you remark it works abnormally, stop using.
- Only one person can use it at time.
- Consult your physician before starting any exercise. It is especially necessary if you are over 35 years of age or if you have some problems. If you feel faintly or remark other health complications, stop immediately. Don't use it, if you have health complications or if you take some medical care.
- Avoid using if you have: leg pain, waist pain, wounded neck, waist, leg, arthritis, rheumatic, gout, osteoporosis, perfunctory obstacles (heart problems, wrong blood circulation, hypertension), respiratory complications, sarcomata, thrombus, diabetes, skin irritation, hyperpyrexia, bone problems, if you are pregnant or have catamenia or similar problems.
- **Weight limit:** 120 kg
- **Category:** SC (according to EN957 norm) suitable for semi-commercial, hotel and Club use.
- **WARNING!** The heart rate frequency monitoring may not be completely accurate. Overexertion during training can lead to a serious injury or even death. If you start to feel faint, stop the exercise immediately.

EXPLODED DRAWINGS

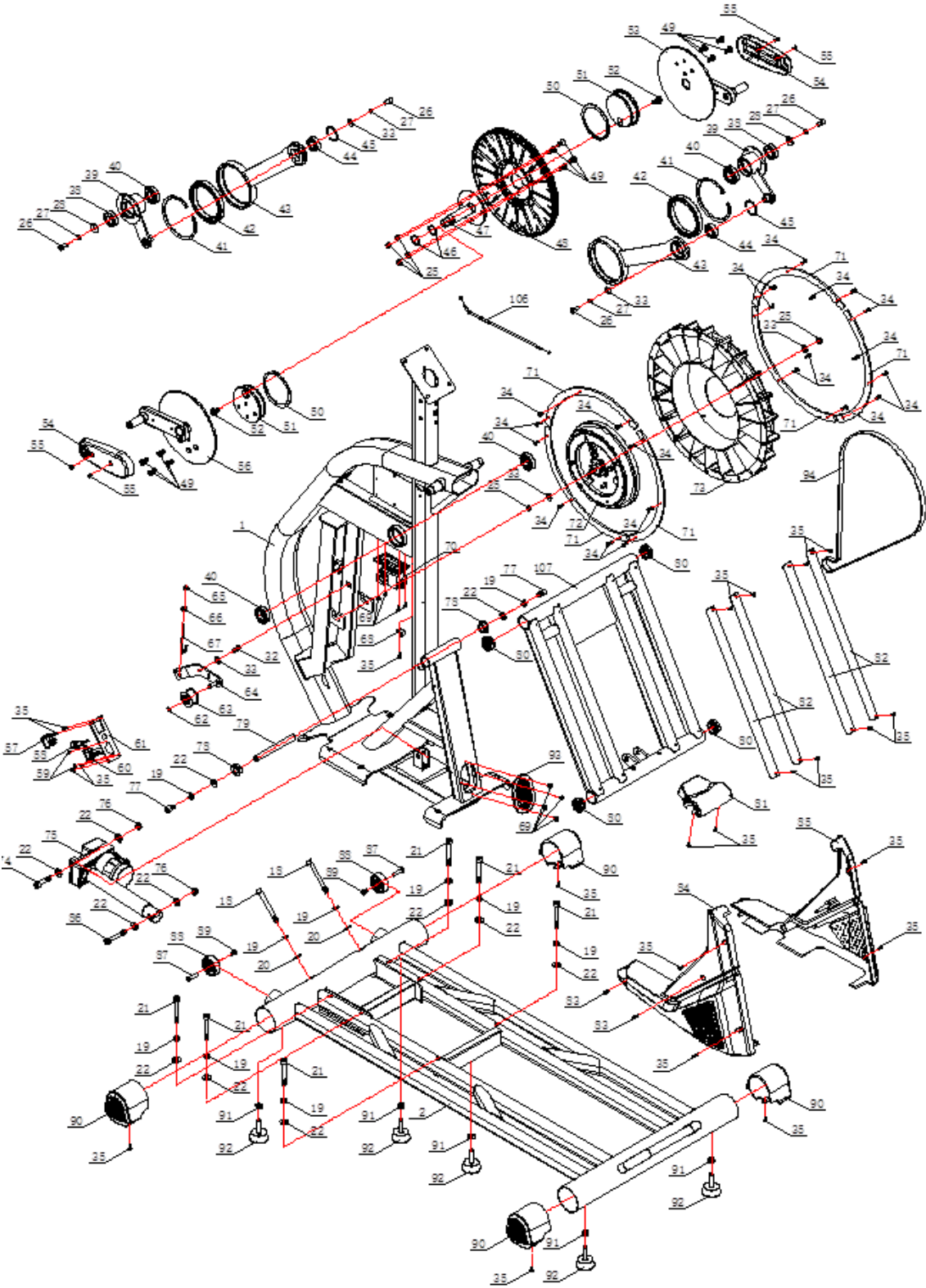

PARTS LIST

No.	Description	Specification	Qty.
1	Main frame		1
2	Basic frame		1
3	Left pedal connection leg		1
4	Right pedal connection leg		1
5	Left pedal		1
6	Right pedal		1
7	Left upper swing arm		1
8	Right upper swing arm		1
9	Handlebar		1
10	Console		1
11	I-Pad holder	Optional	1
12	Tube cap	Ø55	4
13	Roll wheel position stopper	Ø17xØ8.5x47	2
14	Communication line A	L-650 mm	1
15	Hand pulse communication line	L-550 mm	2
16	Hand pulse communication console line		2
17	Communication line A of console		1
18	Allen cylinder head full-thread screw	M10x90x20	2
19	Spring washer	Ø10	10
20	Curved washer	Ø10.5xR100xt2.0	2
21	Allen cylinder head half-thread bolt	M10x70x20	6
22	Flat washer	Ø10x Ø22x2.0	12
23	Allen pan-head half-thread bolt	M8x40x20	4
24	Curved washer	Ø8.5xR25xt2.0	8
25	Hex self-locking nut	M8	12
26	Allen cylinder head full-thread bolt	M8x15	12
27	Spring washer	Ø8	18
28	Flat washer	Ø8.2x Ø25xt2.0	4
29	Allen cylinder head half-thread bolt	M8x60x20	2
30	Allen cylinder head full-thread bolt	M6x15	6
31	Spring washer	Ø6	6
32	Allen pan head full-thread bolt	M8x20	7
33	Flat washer	Ø8.5xØ20xt1.5	13
34	Philips CKS full-thread bolt	M5x15	25
35	Philips CKS self-tapping screw	ST4x16 (optional)	30

36	Communication line B	L-650 mm	1
37	Communication line B of console		1
38	Deep-groove ball bearing	6004-ZZ	6
39	Swing arm		2
40	Deep-groove ball bearing	6005-ZZ	4
41	Spring washer	Ø120	2
42	Deep-groove ball bearing	61819	2
43	Eccentric fixer		2
44	Deep-groove ball bearing	6203-ZZ	2
45	Spring washer	Ø40	2
46	Spring washer	Ø25	2
47	Crank axle group	Ø25x133	1
48	Belt pulley	Ø308.9x22.2	1
49	Allen counter-sunk head full-thread bolt	M8x20	12
50	Spring washer	Ø95	2
51	Eccentric wheel	Ø103x26	2
52	Allen big head full-thread bolt	5/16-18UNC-25	2
53	Crank-right		1
54	Crank cover		2
55	Phillips CKS full-thread bolt	M5x10	4
56	Crank-left		1
57	Switch		1
58	Re-set switch	6A	1
59	Allen countersunk head self-tapping screw	ST3x10	2
60	Socket		1
61	Socket fixer		1
62	Spring washer	Ø10	1
63	Tensioning wheel	Ø43.5x25	1
64	Tensioning wheel fixer		1
65	Allen nut	M6	1
66	Flat washer	Ø6XØ20XT2.0	1
67	Hook	103XØ26XM6x50	1
68	Magnet sensor fixer		1
69	Philips self-tapping screw	ST4x12	8
70	Magnet control motor		1
71	Flywheel weight stack		6
72	Inside magnet flywheel		1
73	Flywheel	Ø450x62	1

74	Allen cylinder head half-thread bolt	M10x45x20	1
75	Incline motor		1
76	Hex self-locking nut	M10	2
77	Allen cylinder head full-thread bolt	M10x15	2
78	Powder case	Ø32xØ16x12.7	2
79	Sliding rail axle	Ø16x145.5	1
80	Tube cap	Ø38x17.5	4
81	Sliding rail tube cover		1
82	Sliding rail aluminium sheet		4
83	Philips CKS self-tapping screw	ST4x20	8
84	Bottom cover-left		1
85	Bottom cover-right		1
86	Allen cylinder head half-thread bolt	M10x60x20	1
87	Allen CKS hollow bolt	Ø8x33xM6x15	2
88	Wheels	Ø55x25.8	2
89	Allen pan head full-thread bolt	M6x12	10
90	Tube cap		4
91	Hex nut	M10	5
92	Feet pad	Ø49x22xM10x40	5
93	Rubber case	110x75x3	1
94	Motor belt	560PJ8	1
95	Top cover-middle		1
96	Top cover-left		1
97	Top cover-right		1
98	Water cup holder		1
99	Hand pulse		2
100	Philips pan head self-tapping screw	ST3x30	4
101	Out cover-left		1
102	Out cover-right		1
103	Out cover decoration strip		2
104	Philips CKS self-tapping screw	ST4x10	6
105	Spring washer	Ø42	2
106	Brake line		1
107	Sliding rail group		1
108	Philips CKS full-thread bolt	M4x10	8
109	Wheel cover-left		2
110	Wheel cover-right		2
111	Wheels	Ø79x37.8	4

112	Pedal fixer		2
113	Tube cap	Ø32xt1.5	2
114	Power line with computer tail		1
115	Tube cap	Ø32x17	2
116	Foam	Ø30xt3.0x350	2
117	Magnet sensor	L-300 mm	1
118	Communication line	L-200 mm	1
119	Power line	L-450 mm	1
120	Power line	L-450 mm	1
121	Controller		1
122	Tube cap	Ø39x Ø30x27.5	4

PRODUCT DESCRIPTION

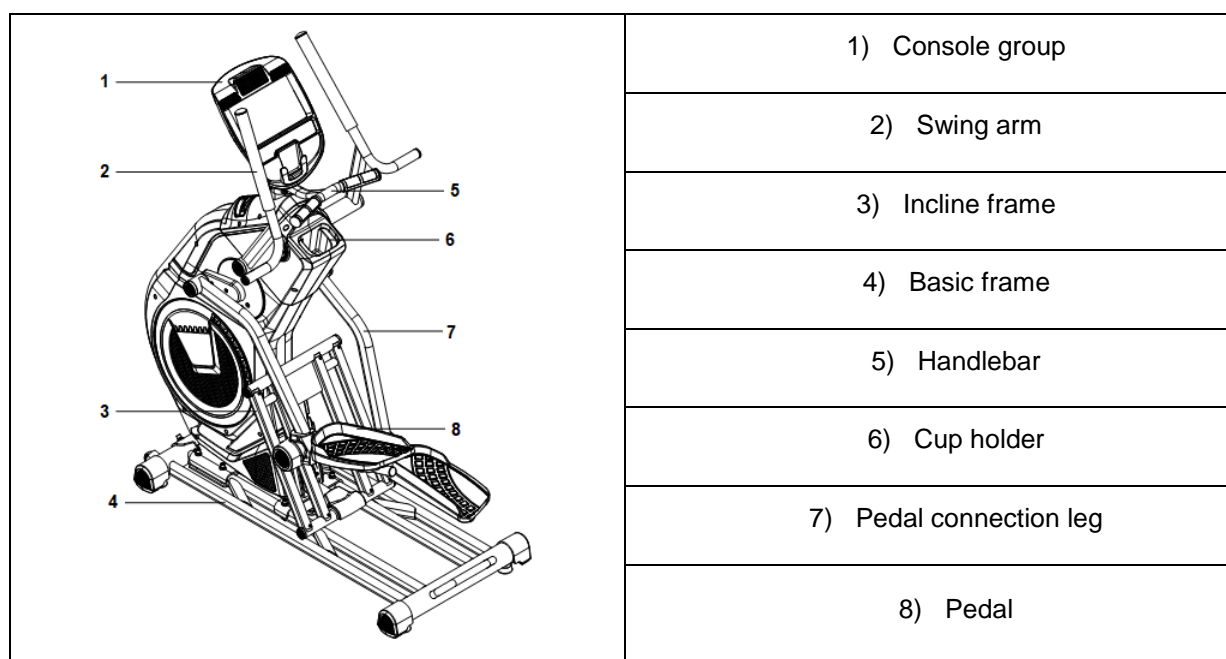

PRODUCT SPECIFICATION

Model No.	E13
Dimensions (unfold)	1660x880x1780 mm
Max. user weight	120 kg
Speed ratio	8.8
Flywheel	Inside magnet, two-way, Ø450/8kg
Resistance level	1-24
Stride length	264 mm

NOTE: The producer reserves the right to amend this product without any prior notice.

HARDWARE LIST

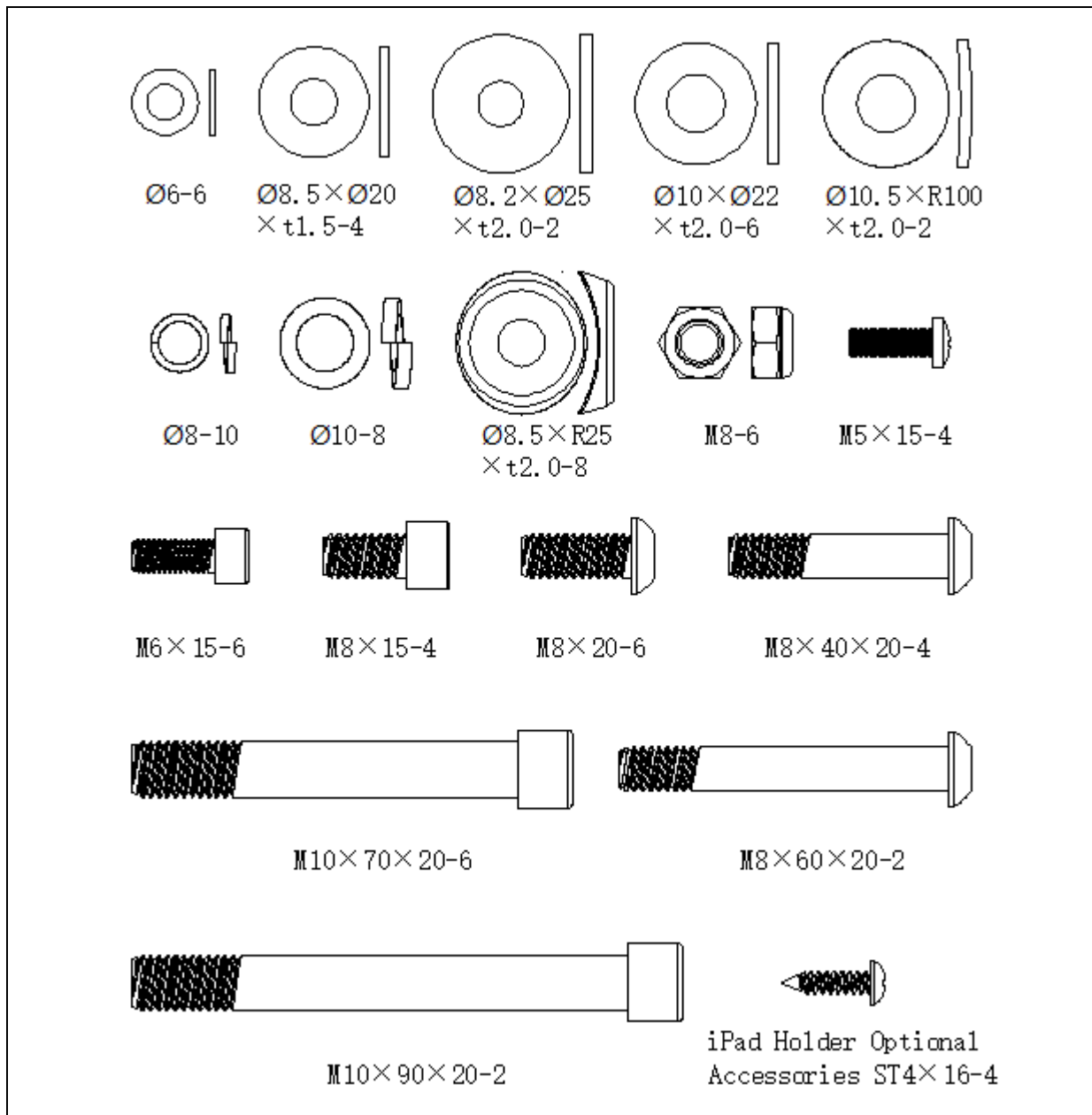

No.	Description	Specification	Qty.
18	Allen cylinder head full-thread screw	M10x90x20	2
19	Spring washer	Ø10	8
20	Curved washer	Ø10.5xR100xt2.0	2
21	Allen cylinder head half-thread bolt	M10x70x20	6
22	Flat washer	Ø10x Ø22x2.0	6
23	Allen pan-head half-thread bolt	M8x40x20	4
24	Curved washer	Ø8.5xR25xt2.0	8
25	Hex self-locking nut	M8	6
26	Allen cylinder head full-thread bolt	M8x15	4
27	Spring washer	Ø8	10

28	Flat washer	Ø8.2x Ø25xt2.0	2
29	Allen cylinder head half-thread bolt	M8x60x2.0	2
30	Allen cylinder head full-thread bolt	M6x15	6
31	Spring washer	Ø6	6
32	Allen pan head full-thread bolt	M8x20	6
33	Flat washer	Ø8.5xØ20xt1.5	4
34	Philips CKS full-thread bolt	M5x15	4
35	Philips CKS self-tapping screw	ST4x16 (optional)	4

TOOLS:

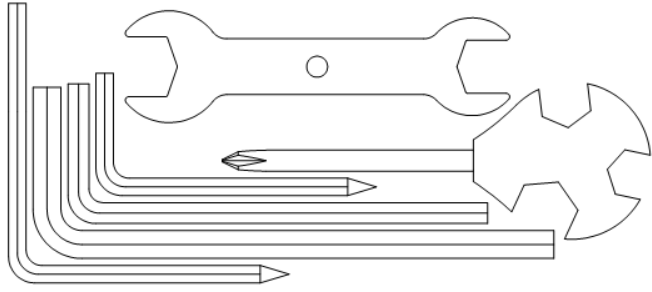
		
Description	Specification	Qty.
L wrench	5x80x80S	1
L wrench	5x35x85S	1
L wrench	6x40x120	1
L wrench	8x45x145	1
Philips wrench	14x17x75	1
Open end wrench	15#&17#	1

ASSEMBLY STEPS

STEP 1

- Place the main frame (1) on the basic frame (2) and secure with six allen cylinder head half-thread screws (21), six spring washers (19), six flat washers (22), two allen cylinder head half-thread screws (18), two spring washers (19), two curved washers (20). Use included Philips wrench.
- **WARNING!** First put all the bolts and washers onto the frame holes. Thereafter secure them.

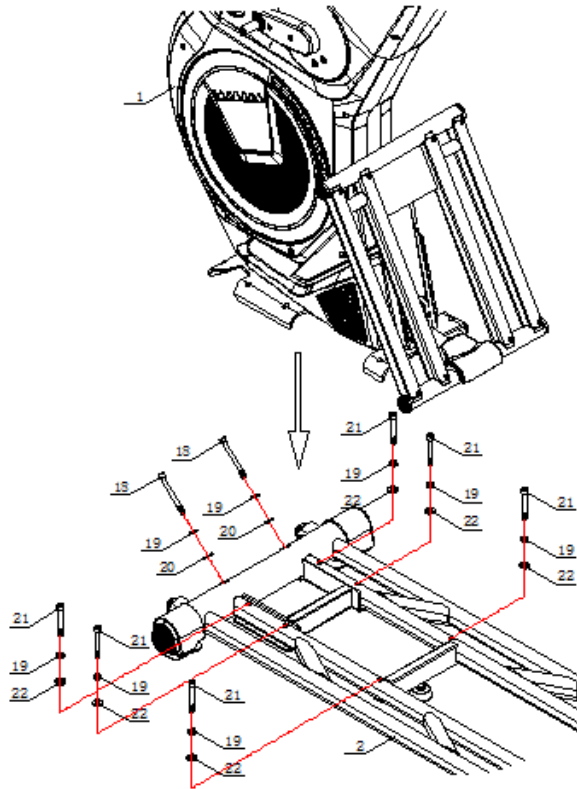

STEP 2

- Insert the left pedal connection leg (3) into the left pedal (5) and secure with two allen pan head half-thread bolts (23), two curved washers (24), two hex self-locking nuts (25), one curved washer (24), one spring washer (27), one allen cylinder head full-thread bolt (26).
- Assemble the right pedal connection leg (4) and the right pedal (6) in the same way.
- **WARNING!** First put all the bolts and washers onto the frame holes. Thereafter secure them.

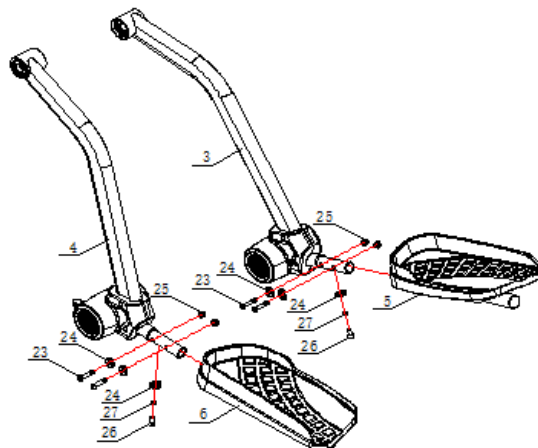

STEP 3

- Assemble the left pedal group (3) on the main frame (1) and secure with one flat washer (28), one spring washer (27), one allen cylinder head full-thread bolt (26). Then assemble the tube cover (12) on the left pedal group (3).

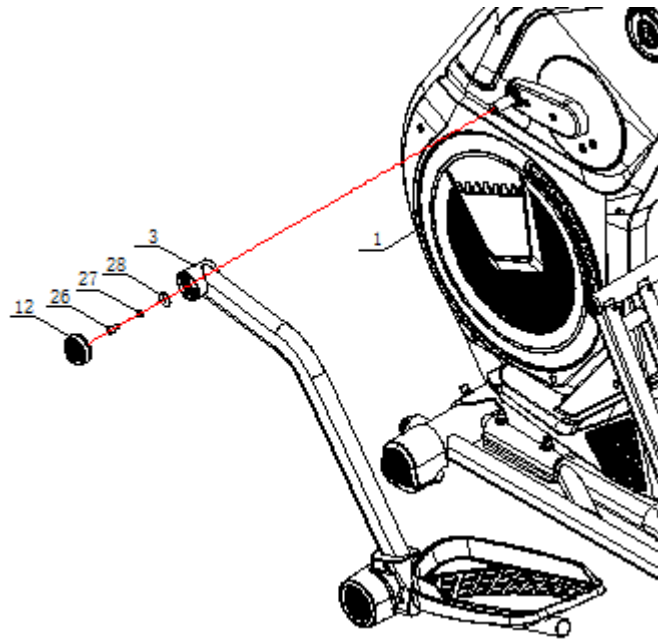

STEP 4

- Assemble the right pedal group (4) on the main frame (1) and secure with one flat washer (28), one spring washer (27) and one allen cylinder head full-thread bolt (26). Then assemble the tube cover (12) on the right pedal group (4).

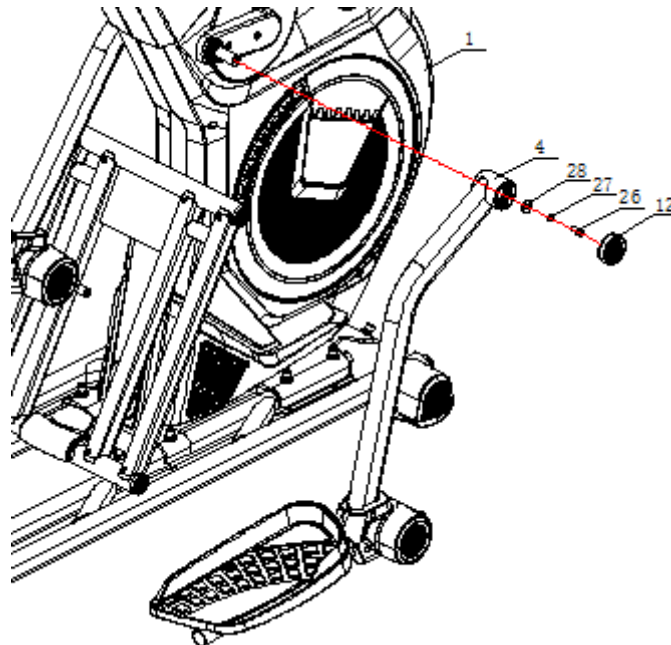

STEP 5

- Assemble one roll wheel position stopper (13) on the left pedal group (3) and secure with one hex self-locking nut (25) and one allen pan head half-thread bolt (29).
- Assemble one roll wheel position stopper (13) on the right pedal group (4) in the same way.

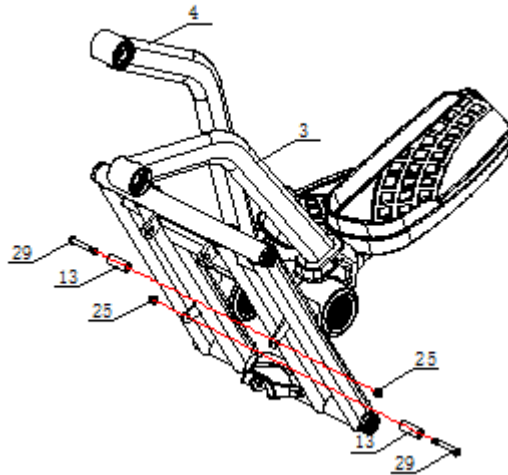

STEP 6

- Assemble the left upper swing arm (7) on the main frame (1). Secure with three spring washers (31) and three allen cylinder head full-thread bolts (30).
- **WARNING!** First put all the bolts and washers onto the frame holes. Thereafter secure them.

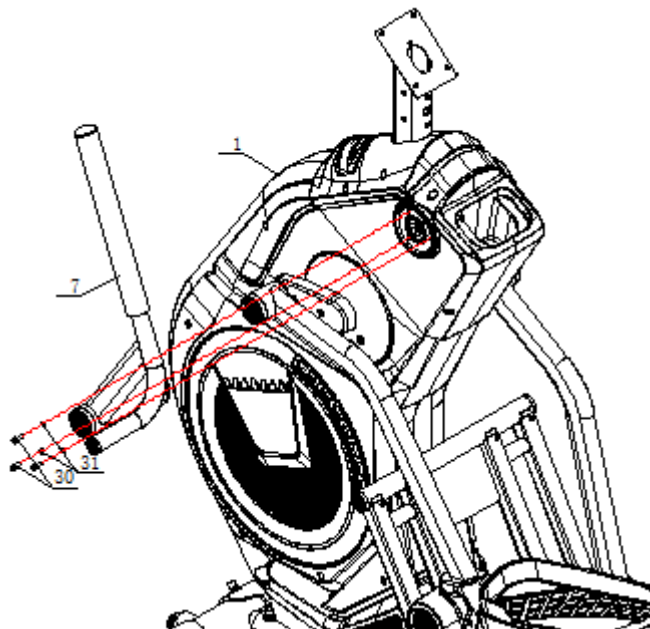

STEP 7

- Assemble the left upper swing arm (8) on the main frame (1). Secure with three spring washers (31) and three allen cylinder head full-thread bolts (30).
- **WARNING!** First put all the bolts and washers onto the frame holes. Thereafter secure them.

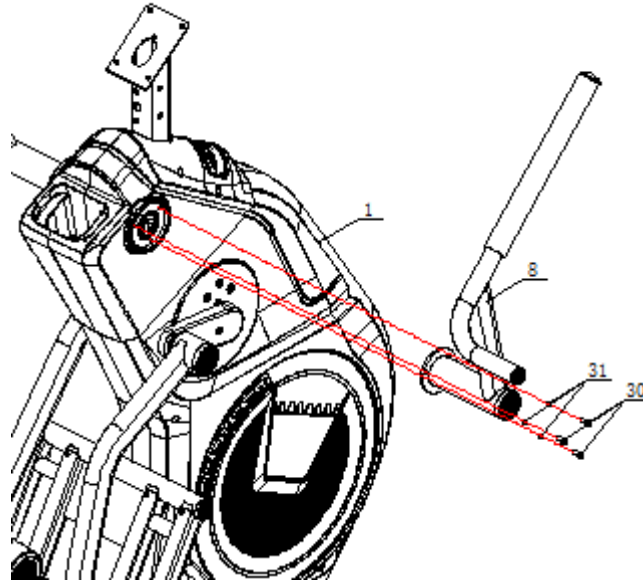

STEP 8

- Put the hand pulse communication line (15) through the hole of the main frame group (1). Place the line on the console fix plate.
- Insert the handlebar group (9) into the main frame (1) and secure with four flat washers (33), four spring washers (27), four allen pan head full-thread bolts (32), two curved washers (24) two spring washers (27), two allen pan head full-thread bolts (32).
- **WARNING!** First put all the bolts and washers onto the frame holes. Thereafter secure them.

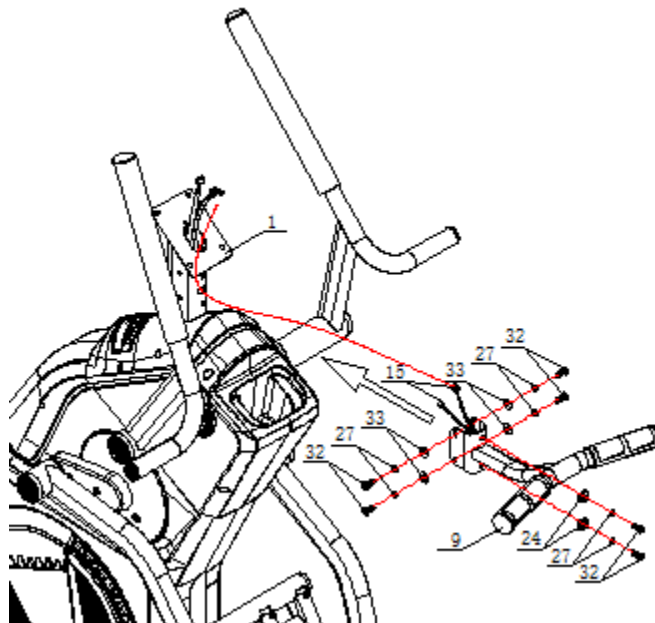

STEP 9

- Connect the communication line of the console A (17) and the communication line A (14), hand pulse line of the console (16) and the hand pulse line (15), communication line B (37), communication line B (36). Assemble the console group (10) on the main frame (1) and secure with four Philips CKS full-thread bolts (34).

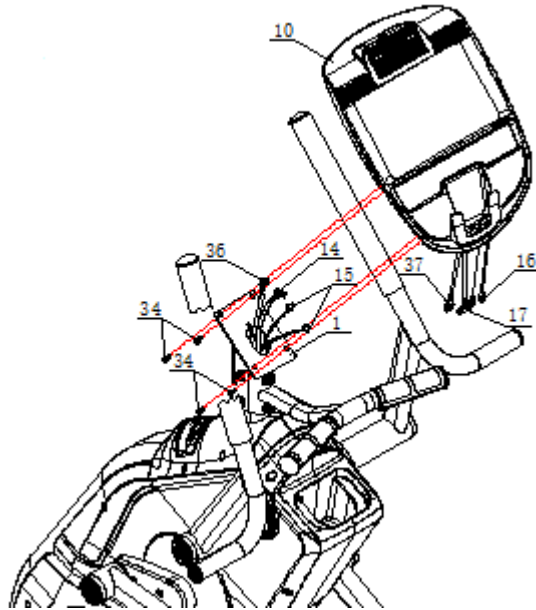



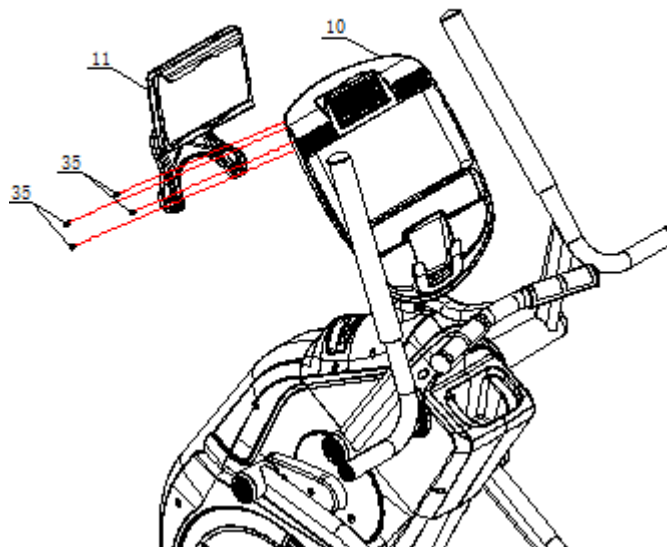

STEP 10 (OPTIONAL)

- Place the I-pad holder (11) on the console group (8) and secure with four Philips CKS self-tapping screws (35).
- **WARNING!** If you buy an I-pad holder, this step is necessary. Otherwise you can skip it.



EXERCISE INSTRUCTIONS

A successful workout starts with the warm-up phase and ends with the cool-down phase (relaxation). At the warm-up phase your muscle should be prepared for strenuous workout. The cool-down phase should protect your body from muscular problems. Follow stretching exercise instructions for warming up and cooling down your body.

	<p>Touching your toes</p> <p>Slowly bend your back from hips. Keep your back and arms relaxed while stretching downwards to your toes. Do it as far as you are able and hold the position for 15 seconds. Bend your knees slightly.</p>
	<p>Upper thigh</p> <p>Lean against a wall with one hand. Reach down and behind you. Lift up your right or left foot to your buttock as high as possible. Keep for 30 seconds and repeat twice for each leg.</p>
	<p>Hamstring stretched</p> <p>Sit and outstretch your right leg. Rest the sole of your left foot against the inside of your right thigh. Stretch out your right arm along your right leg as far as you can. Hold for 15 seconds and relax. Repeat all with your left leg and left arm.</p>
	<p>Inside upper thigh</p> <p>Sit on the floor and place your feet together. Knees are pointed outwards. Pull your feet as close as possible to your groin. Press your knees carefully downwards. Keep this position for 30-40 seconds if possible.</p>
	<p>Calves and Achilles tendon</p> <p>Lean against a wall with your left leg in front of the right one and your arms forward. Stretch out your right leg and keep your left foot on the floor. Bend your left leg and lean forwards by moving your right hip in the direction of the wall. Hold for 30-40 seconds. Keep your leg stretched and repeat exercising with other leg.</p>

CONSOLE OPERATON INSTRUCTION



Functional description:

- Manual: adjust exercise mode.
- Program: 12programs (P1~P12) adjust the load level automatically.
- Watt: display power consumption during training.
- HRC: Set 55%/75%/90%/TARGET, adjust load level base on heartbeat value automatically.
- User program: self-selected load to exercise
- Recovery: recover the heart rate test
- Bodyfat: To test user's body fat and fat ratio.
- User data: Set user information, you can choose UX(X=1~4).
- Incline function: (01~15) levels
- Music speaker
- USB charging function.

Main function Description

Function	Display range	Setting range	Memorize	Return to 0	Description
Time	0:00 ~ 99:59 Minute	0~99 Circulation (+- 1 minute)	Yes	Yes	a. Count – no preset target, time will count from 0:00. b. Count down – with preset target, time will count down from preset to 0, then system STOP. The indicator light of TIME flash, and system alarm 8s with 4 sounds in every second. (Press

					any key to stop alarm)
SPEED	0.0~99.9 KMH 0.0~99.9 MLH	Can't be preset	No	Yes	In START mode: a. With sensor input, screen display training speed in 3s. b. Without sensor input for 4.6s, the SPEED value is 0. c. SPEED & RPM value will display 6s by turn in same window.
RPM	0~999	Can't be preset	No	Yes	In START mode: a. With sensor input, screen display training RPM in 3s. b. Without sensor input for 4.6s, the RPM value is 0. c. SPEED & RPM value will display 6s by turn in same window.
DISTANCE	0.0~99.99 KM (ML)	0.0 ~99.90 (+0.1)	Yes	Yes	a. Count – no preset target, time will count from 0.0. b. Count down – with preset target, time will count down from preset to 0, then system STOP. The indicator light of DISTANCE flash, and system alarm 8s with 4 sounds in every second. (Press any key to stop alarm)
CALORIES	0~9999 CAL	0~9990 (+10)	Yes	Yes	a. Count – no preset target, time will count from 0. b. Count down – with preset target, time will count down from preset to 0, then system STOP. The indicator light of CALORIES flash, and system alarm 8s with 4 sounds in every second. (Press any key to stop alarm)
PULSE	P-30~230 BPM	0-30~230 (+1) BPM Circulation	Yes	Yes	a. With pulse input, screen display initial value in 7.5s. b. Without pulse input in 6s, the PULSE value is 0. c. Pulse exceed the preset target, console will remind with Bi-bi sound.
WATT	0~999	Can't be preset	Yes	Yes	a. With sensor input, screen display WATT value in 3s.

					d. Without sensor input for 4.6s, the WATT value is 0.
AGE	1~99	1~99	Yes	Yes	The indicator light flash waiting for preset, the screen display default value is 25.
RECOVERY	F1~F6	Can't be preset	No	No	To display the PULSE input value.
MANUAL		1~24LEVEL	Yes	Yes	a. Press ▲, ▼KEY to preset LEVEL. b. CPU adjust the resistance base on LEVEL preset value.
PROGRAM	(P1~P12)	(P1~P12)	Yes	Yes	a. Press ▲, ▼KEY to preset PROGRAM. When you select, the indicator light flash, press MODE confirm your selection. b. CPU adjust the resistance base on LEVEL preset value.
USER		16X*8Y	Yes	Yes	a. When you select, the indicator light flash, press MODE confirm your selection. b. USER can preset one PROGRAM.
H.R.C		55%,75%,90%,TAG	Yes	Yes	a. When you select, the indicator light flash, press MODE confirm your selection. b. Before this preset, you must set the AGE first.
WATT CONSTANT		(10~350) (+5) Circulation	Yes	Yes	a. When you select, the indicator light flash, press MODE confirm your selection. b. The default value is 120, finished preset, press the START to conduct this WATT CONSTARNT function.
CIRCLE		Can't be preset	Yes	No	Select by OPTION
LEVEL	Display 1~24	1 ~24	No	No	Screen display LEVEL value when you select and adjust this function.
SEX	Male OR Female	Male OR Female	Yes	No	Select Male or Female.
HEIGHT	100~200 CM	100~200 (+1) CM 40~80 (+1) INCH	Yes	Yes	a. Set the height of user, as the calculation parameter of exercise, preset value is 160CM (60 INCH). b. When you select, the indicator light of "HT"

					flash.
BODY FAT	20~150 KG	20-150 KG (+-1) KG 40~350 LB (+-1)	Yes	Yes	a. Set the weight of user, as the calculation parameter of exercise, preset value is 50KG (100 LB). b. When you select, the indicator light of "WT" flash.
BMI	5.0%~50%	Can't be preset	No	No	LED display.
INC	0~50	Can't be preset	Yes	No	LED display.

OPERATION DESCRIPTION

POWER ON:

- Connect power or when step RPM>, (self-power generation), buzzer sounds for 1s and LED will full display 2S /drawing 1). Then display KM or ML in center of screen.
- Enter USER setting mode (with FAT function), input user information U1~U4, select one user (Drawing 3), press MODE / ENTER KEY to select SEX (Drawing 4), AGE (Drawing 5), HEIGHT (Drawing 6), WEIGHT (Drawing 7). When you select, the window show the default value or previous record, then go to main function window (Drawing 8 MANUAL · PROGRAM · User Program · H.R.C. · WATT function).

SLEEP:

- If SM&SE system without any RPM information input 4 minutes, the console will enter sleep mode, the console will wake up if any RPM information input.
- SR system without any RPM information input 90s, the console will be in sleep mode, the console will wake up when sensor input >15RPM.

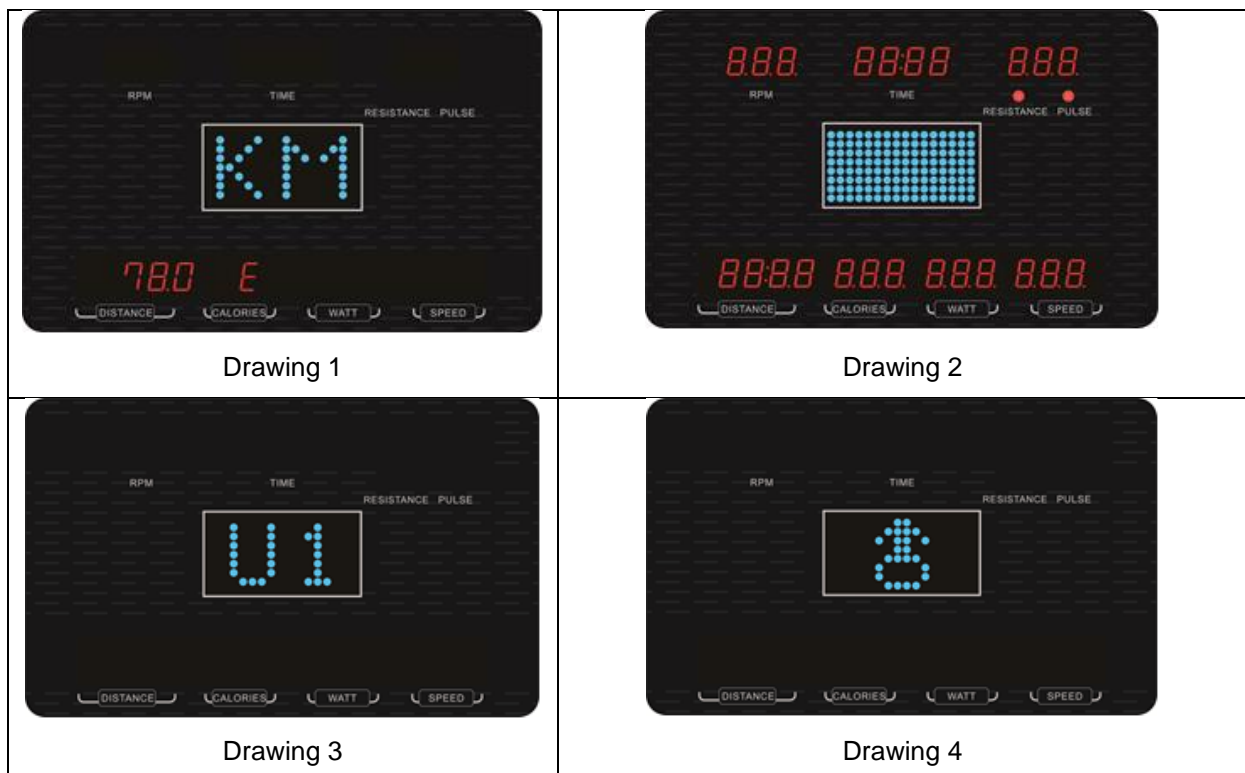



Drawing 5



Drawing 6



Drawing 7

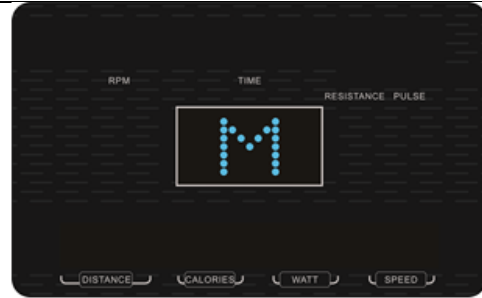

Drawing 8

FUNCTION CIRCULATION: MANUAL – PROGRAM-USER-HRC-WATT

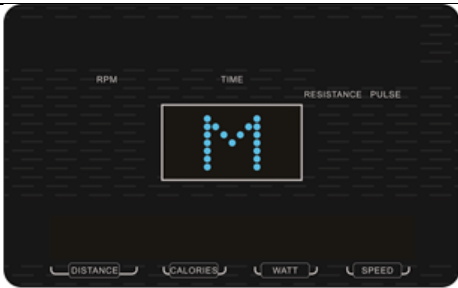

Drawing 9

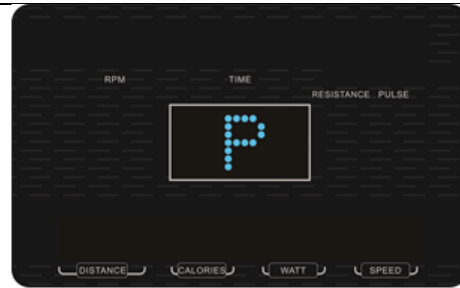

Drawing 10



Drawing 11

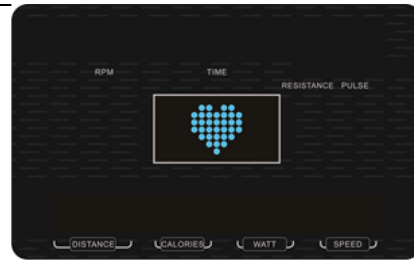

Drawing 12



Drawing 13

MANUAL MODE (PRESS START/STOP KEY)

- A. Select MANUAL mode to adjust setting value, use MODE key to select, press UP /DOWN to set the value. TIME (Drawing 14) DISTANCE (Drawing 15) CALORIES (Drawing 16) PULSE (Drawing 17)
- B. Press START/STOP key to start exercise, press UP or DOWN key to adjust resistance during exercise.
- C. During exercise, press START/STOP key, the console will change from LEVEL mode to INC mode automatically, press +/- adjust the incline height.
- D. Re-press START/STOP key, console pause, press RESET to enter the new program.

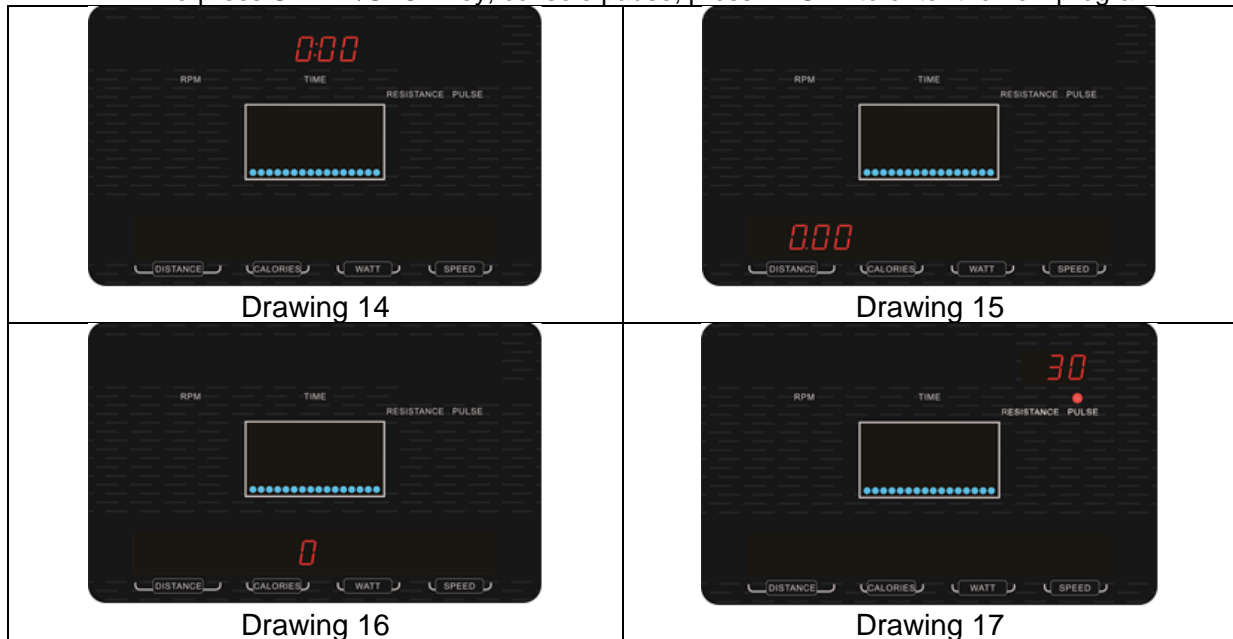

PROGRAM MODE

- A. Select PROGRAM mode, press UP/DOWN to choose P1~P12 (Drawing 18~Drawing 29)
- B. Enter time window, press UP/DOWN key to adjust (Drawing 30)
- C. Press START/STOP key to start exercise, press UP or DOWN key to adjust resistance during exercise.
- D. During exercise, press START/STOP key, the console will change from LEVEL mode to INC mode automatically, press +/- adjust the incline height.
- E. Re-press START/STOP key, console pause, press RESET to enter the program.





Drawing 20



Drawing 21



Drawing 22



Drawing 23



Drawing 24



Drawing 25



Drawing 26



Drawing 27



Drawing 28



Drawing 29

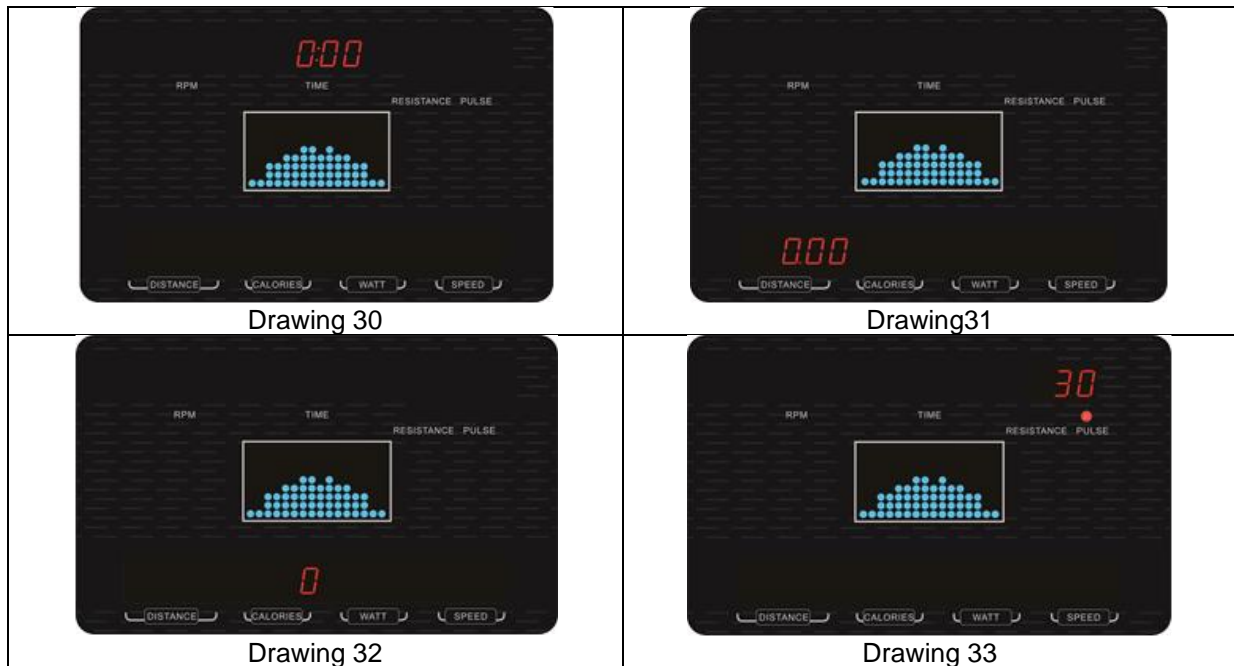

USER MODE

- A. Select USER mode, press UP/DOWN key to set USER PROGRAM (Drawing 34) Press MODE key 2s to skip this setting, (keep previous record, or keep as LOAD 1 if no setting before)
- B. Enter time window, press UP/DOWN key to adjust (Drawing 35)
- C. Press START/STOP key to start exercise, press UP or DOWN key to adjust resistance during exercise.
- D. During exercise, press START/STOP key, the console will change from LEVEL mode to INC mode automatically, press +/- adjust the incline height.
- E. Re-press START/STOP key, console pause, press RESET enter to choose program.



HRC MODE

- A. Enter HRC mode, press UP/DOWN key to select 55%(107) 75%(146) 90%(175) TAG (100) (Drawing 36~Drawing 39)
- B. Enter time window, press UP/DOWN key to adjust (Drawing 40).
- C. Press START/STOP key to start exercise, press UP or DOWN key to adjust resistance during exercise.
- D. During exercise, press START/STOP key, the console will change from LEVEL mode to INC mode automatically, press +/- adjust the incline height.
- E. Re-press START/STOP key, console pause, press RESET to enter and choose program
- F. The window will show, if no heartbeat input. (Drawing 41).



WATT MODE

- Enter WATT mode, press UP/DOWN key to adjust the value (Default value is 120W) (Drawing 41)
- Enter time window, press UP/DOWN key to adjust (Drawing 42)
- Press START/STOP key to start exercise, based on the value of WATT to adjust resistance automatically.
- During exercise, press START/STOP key, the console will change from LEVEL mode to INC mode automatically, press +/- adjust the incline height.
- Re-press START/STOP key, console pause, press RESET to enter and choose program.

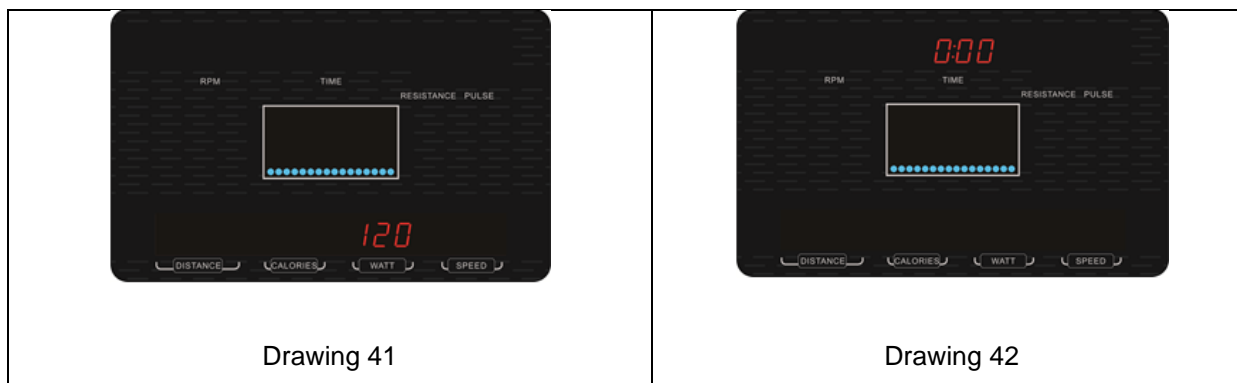

OPERATING KEY

Console with key alarm function (Valid KEY: 1 short sound, Invalid KEY: 2 short sound, count down to zero: 4 short sound in every second, H.R.C & WATT CONTROL stop forcedly: 6 short sound continuously, PULSE over setting value: 2 short sound in every second, WATT OVER SPEC:3 short sound in every second).

UP/DOWN KEY

- Press up this button to add or reduce value 1, long press to add or reduce value continuously. Select user U1~U4 (Age, Sex, Weight, Height) Select MANUAL, PROGRAM, USER, HRC, WATT function

INCLINE KEY

- INC UP/INC DOWN (Level 1~15)
- Press this button to add or reduce value 1 UP MODE Key
 1. Select function(TIME, DIST, CAL, PULSE) ect
 2. After select or preset value, press this key go to next step.

MODE KEY

- Select function(TIME, DIST, CAL, PULSE) ect
- After select or preset value, press this key go to next step.

RESET KEY

1. RESET : Press RESET key when system under STOP state, enter the main function window to select (WATT, H.R.C, User, PROGRAM, MANUAL function) and clear previous record of TIME, DISTANCE, CALORIES, PULSE, WATT).
2. TOTAL RESET : Press RESET key 2s, enter to just power on state, which is TOTAL RESET. system with 1s long sound alarm, and enter setting mode 2s later, the system is stand by LEVEL 1 waiting for preset.

START/STOP KEY

- Press this key to start exercise, press it one more time, the console stop.

RECOVERY

1. If no PULSE input, this key is invalid.
2. In START or STOP state display PULSE value, press RECOVERY key :
 - A, Conduct RECOVERY function, display TIME and PULSE window only. Voltage value of LEVEL reduce to LEVEL 1 immediately.
 - B, TIME window display 0:60(Drawing 43), start to time count down (if no PULSE input during time count down, the window display "F1~F6" when the time count down to 0). Press the RECOVERY key resume display.
3. Press this key during time count down, resume normal display.



BODY FAT

- Under STOP state, after finish user's information, this function is ready.
- Press this key to test body fat ratio, put your hands on the handlebar, the test result display on the window (Drawing 45~Drawing 47).
- If window display E-1(Drawing 48), which means not hold the handlebar closely.
- If the window display E-1(Drawing 49), which means the bodyfat ratio over setting range (5%~50%).
- After test, the FAT% and BIM will display on the window (Drawing 50, Drawing 51, Drawing 52).
- Press BODY FAT key one more time during test to cancel this function.

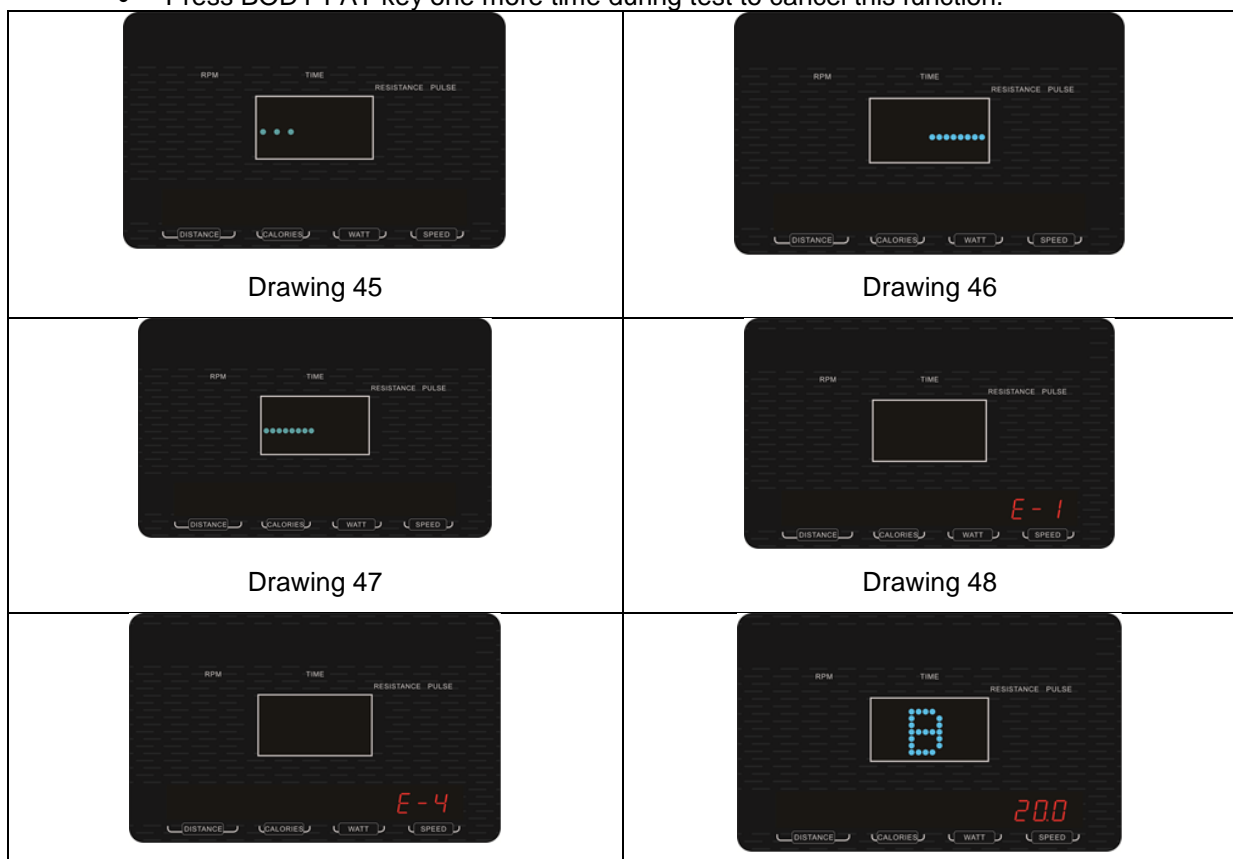



TERMS AND CONDITIONS OF WARRANTY, WARRANTY CLAIMS

General Conditions of Warranty and Definition of Terms

All Warranty Conditions stated hereunder determine Warranty Coverage and Warranty Claim Procedure. Conditions of Warranty and Warranty Claims are governed by Act No. 40/1964 Coll. Civil Code, Act No. 513/1991 Coll., Commercial Code, and Act No. 634/1992 Coll., Consumer Protection Act, as amended, also in cases that are not specified by these Warranty rules.

The seller is SEVEN SPORT s.r.o. with its registered office in Borivojova Street 35/878, Prague 13000, Company Registration Number: 26847264, registered in the Trade Register at Regional Court in Prague, Section C, Insert No. 116888.

According to valid legal regulations it depends whether the Buyer is the End Customer or not.

“The Buyer who is the End Customer” or simply the “End Customer” is the legal entity that does not conclude and execute the Contract in order to run or promote his own trade or business activities.

“The Buyer who is not the End Customer” is a Businessman that buys Goods or uses services for the purpose of using the Goods or services for his own business activities. The Buyer conforms to the General Purchase Agreement and business conditions to the extent specified in the Commercial Code.

These Conditions of Warranty and Warranty Claims are an integral part of every Purchase Agreement made between the Seller and the Buyer. All Warranty Conditions are valid and binding, unless otherwise specified in the Purchase Agreement, in the Amendment to this Contract or in another written agreement.

Warranty Conditions

Warranty Period

The Seller provides the Buyer a 24 months Warranty for Goods Quality, unless otherwise specified in the Certificate of Warranty, Invoice, Bill of Delivery or other documents related to the Goods. The legal warranty period provided to the Consumer is not affected.

By the Warranty for Goods Quality, the Seller guarantees that the delivered Goods shall be, for a certain period of time, suitable for regular or contracted use, and that the Goods shall maintain its regular or contracted features.

The Warranty does not cover defects resulting from (if applicable):

- User’s fault, i.e. product damage caused by unqualified repair work, improper assembly, insufficient insertion of seat post into frame, insufficient tightening of pedals and cranks
- Improper maintenance
- Mechanical damages
- Regular use (e.g. wearing out of rubber and plastic parts, moving mechanisms, joints etc.)
- Unavoidable event, natural disaster

- Adjustments made by unqualified person
- Improper maintenance, improper placement, damages caused by low or high temperature, water, inappropriate pressure, shocks, intentional changes in design or construction etc.

Warranty Claim Procedure

The Buyer is obliged to check the Goods delivered by the Seller immediately after taking the responsibility for the Goods and its damages, i.e. immediately after its delivery. The Buyer must check the Goods so that he discovers all the defects that can be discovered by such check.

When making a Warranty Claim the Buyer is obliged, on request of the Seller, to prove the purchase and validity of the claim by the Invoice or Bill of Delivery that includes the product's serial number, or eventually by the documents without the serial number. If the Buyer does not prove the validity of the Warranty Claim by these documents, the Seller has the right to reject the Warranty Claim.

If the Buyer gives notice of a defect that is not covered by the Warranty (e.g. in the case that the Warranty Conditions were not fulfilled or in the case of reporting the defect by mistake etc.), the Seller is eligible to require a compensation for all the costs arising from the repair. The cost shall be calculated according to the valid price list of services and transport costs.

If the Seller finds out (by testing) that the product is not damaged, the Warranty Claim is not accepted. The Seller reserves the right to claim a compensation for costs arising from the false Warranty Claim.

In case the Buyer makes a claim about the Goods that is legally covered by the Warranty provided by the Seller, the Seller shall fix the reported defects by means of repair or by the exchange of the damaged part or product for a new one. Based on the agreement of the Buyer, the Seller has the right to exchange the defected Goods for a fully compatible Goods of the same or better technical characteristics. The Seller is entitled to choose the form of the Warranty Claim Procedures described in this paragraph.

The Seller shall settle the Warranty Claim within 30 days after the delivery of the defective Goods, unless a longer period has been agreed upon. The day when the repaired or exchanged Goods is handed over to the Buyer is considered to be the day of the Warranty Claim settlement. When the Seller is not able to settle the Warranty Claim within the agreed period due to the specific nature of the Goods defect, he and the Buyer shall make an agreement about an alternative solution. In case such agreement is not made, the Seller is obliged to provide the Buyer with a financial compensation in the form of a refund.



SEVEN SPORT s.r.o.

Registered Office:	Borivojova 35/878, 130 00 Praha 3, Czech Republic
Headquarters:	Delnicka 957, 749 01 Vitkov, Czech Republic
Warranty & Service Centre:	Cermenska 486, 749 01 Vitkov, Czech Republic
CRN:	26847264
VAT ID:	CZ26847264
Phone:	+420 556 300 970
E-mail:	eshop@insportline.cz reklamace@insportline.cz servis@insportline.cz
Web:	www.insportline.cz

SK

INSPORTLIN s.r.o.

Headquarters, Warranty & Service centre:	Elektricka 6471, 911 01 Trencin, Slovakia
CRN:	36311723
VAT ID:	SK2020177082

Phone: +421(0)326 526 701
E-mail: objednavky@insportline.sk
reklamacie@insportline.sk
servis@insportline.sk
Web: www.insportline.sk

Date of Sale:

Stamp and Signature of Seller: